

Art. No.	Pig troughs	Length, cm.	Outside width, cm.	Outside height, cm.	Volume, l./m.	Weight each.	Troughs per pallet.
02564	TS 25, 1,00 m long	100	30	14,3	22	19	30
02566	Gable end					0,8	100
02850	Partition					0,75	100
18444	TS 28 V, 1,00 m long, for glue	100	34	22	30	36,5	20
18445	Partition					1,2	100
01605	TS 30, 1,00 m long	100	35	16,8	32	20,1	24
17096	TS 30 E 100, 1,00 m long, with gable end	100				20,6	20
17097	TS 30 E 65, 0,65 m long, with gable end	65				13,5	20
01664	Partition					0,95	100
01667	TS 35, 1,00 m long	100	39	21,8	38	26	16
18509	TS 35 R, 1,00 m long, with cleaning opening	100				26	16
17081	TS 35 E 50 R, 0,50 m long, with gable end R	50				16,6	12
17080	TS 35 E 50 L, 0,50 m long, with gable end L	50				16,6	12
01670	Partition					2,1	100
02571	TS 36, 1,00 m long	100	40,8	30	42	31	16
17098	TS 36 E 50 R, 0,50 m long, with gable end R	50				18,8	16
17099	TS 36 E 50 L, 0,50 m long, with gable end L	50				18,8	16
02605	Partition					1,8	100
03191	TS 41, 1,00 m long	100	46	18	50	26,3	22
01595	TS 41 E 100, 1,00 m long, with gable end	100				27	20
01596	TS 41 E 65, 0,65 m long, with gable end	65				18	20
03204	Partition					1,5	100
18455 *	TS 44 S, 1,00 m long, incl. 4 footangle	100	44	22	*	35	84
18976 *	Footangle, Stainless steel					0,15	500
18454 *	Partition					2,6	*
30308016	Set screw M8x16 ST						
01585	TS 47, 1,00 m long	100	52	18	55	32	24
03258	TS 47 R, 1,00 m long, with cleaning opening	100				32	24
01586	TS 47 E 100, 1,00 m long, with gable end	100				35	18
01587	TS 47 E 65, 0,65 m long, with gable end	65			30	25	18
01588	Partition					4	100
02101	TS 50, 1,00 m long	100	50	18	65	32	12
01600	TS 50 E 100, 1,00 m long, with built-in end	100				32	8
01601	TS 50 E 65, 0,65 m long, with built-in end	65				25,2	8
554201	105-R, 1,20 m long	120	46,2	24,2		68	8
554203	105-RS 1,20 m long, with gable end	120				74	5
554157	110, 1,20 m long	120	35	25	33	31	22
554152	110-SV, 1,20 m long, with gable end L					29,1	14
554151	110-SH, 1,20 m long, with gable end R					29,1	14
554170	Partition					1,3	100
554149	115, 1,20 m long	120	51,4	15,6	53	28,1	20
554146	115-S, 1,10 m long, with gable end	110				28,1	11
554128	116, 1,20 m long	120	57,8	17,8	2x21	45,6	10
554162	Partition						100
554147	137-s 1,10 m long, with gable end	110				25,77	11
	Elevation						
09518	TS 100, 1,00 m long	100				9,35	30
09519	TS 65 R, 0,65 m long (Requirement: 2 elevations per double trough)	65				6,23	40

B-8011-01-GB

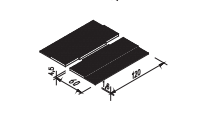

Art. No.	Single trough		Length, cm.	Outside width, cm.	Outside height, cm.	Volume, l./m.	Weight each.	Troughs per pallet.
09550	T 35-50	for encased in concrete	50	38,5	22		19	20
09552	T 35-60	for encased in concrete	60	38,5	22		21,0	20
18333	T 36-49,5	with plug	49,5	38,1	21,8		16,5	20
17297	DT 14 R	right, with plug incl. rubber berings for fastening of screws					14,1	20
17298	DT 14 L	left, with plug incl. rubber berings for fastening of screws					14,1	20
17299	DT 20 R	right, with plug incl. rubber berings for fastening of screws					18,0	20
17300	DT 20 L	left, with plug incl. rubber berings for fastening of screws					18,0	20
Art. No. Cups								
03186	FT 19	Polymer concrete	19	19	8		3,0	48
06906	FTK 27,	with inner edge Polymer concrete	27	27	8		5,7	48
554154	326-T	(230), Polymer concrete	26	26	6		2,5	56
Art. No. Tiles								
554167	Tiles 80x60 cm		80	60	2		17,7	50
554168	Tiles 120x60 cm	for 3 i 1 Feeder for incorporation in partition (Requirement: 2 tiles per feeder)	120	60	4,5		34	25
Art. No. Accessories for troughs								
02163	Polyester Glue	0,5 kg for jointing (approx. 2-3 joints)						
18435	Polyester Glue	4 kg for jointing (ca. 16-26 joints)						
523007	Joint filler	grey 660 ml for jointing (ca. 10-15 joints)						
17520	Flexibel glue	300 ml for jointing						
18990	Joint filler	for feeding tables						

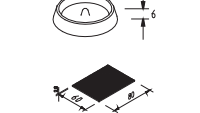
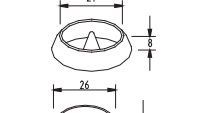
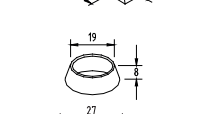
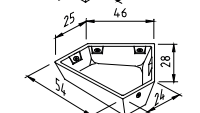
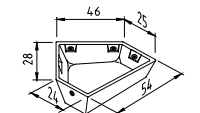
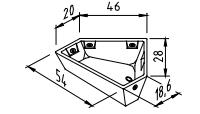
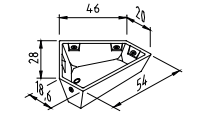
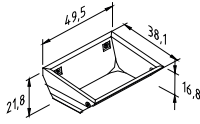
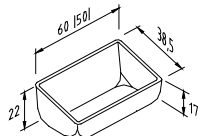
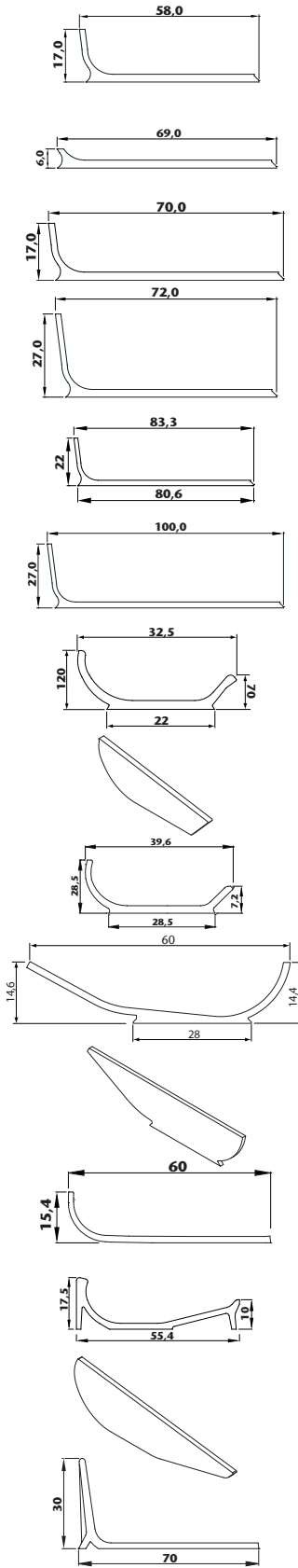

Art. No.	Feed tables	Length, cm.	Outside width, cm.	Outside height, cm.	Volume, l./m.	Weight each.	Troughs per pallet.
09655	KL 60	100	17,0	58,0		30,0	30
17385	KL 70 S	100	6,0	69,0		35,1	25
02326	KL 70	100	17,0	70,0		35,0	20
09693	KL 72	100	27,0	72,0		43,0	18
09657	KL 80	100	22,0	80,0		46,9	20
18268	KL 100	70	27,0	100,0		42,5	14
554145	201	120	12,0	32,5		16,5	40
554160	Partition for 201					1,2	100
554135	202	120	14,2	39,6		21,4	30
02080	KM 60	100	14,6	60,0		24,0	24
02081	Gable end for KM 60					2,6	100
554173	220-F	120	15,4	60,0		31,7	30
554140	225	120	17,5	56,0		37,8	18
554192	Partition for 225					1,6	100
554150	230/70	120	30	70		55,3	12

* DISCONTINUED PART WHEN THERE ARE NO MORE IN STOCK.